

# The EGYPT Centre Teachers Pack Ages 3-5



# Contents

	<i><b>Page</b></i>
Planning your visit	<b>3-5</b>
Useful Information	<b>6</b>
House of Life	<b>7</b>
House of Death	<b>8</b>
Booking Agreement	<b>9</b>
House of Life Gallery plan	<b>10</b>
House of Death Gallery Plan	<b>11</b>
Example Booking Form	<b>12</b>
Other Activities	<b>13</b>
Gift shop	<b>13</b>



# Planning your Visit

## The Egypt Centre & Cynefin

"The place where we feel we belong, where the people and landscape around us are familiar, and the sights and sounds are reassuringly recognisable. Though often translated as 'habitat', cynefin is not just a place in a physical or geographical sense: it is the historic, cultural and social place which has shaped and continues to shape the community which inhabits it."

(<https://hwb.gov.wales/curriculum-for-wales/designing-your-curriculum/cross-cutting-themes-for-designing-your-curriculum/#local,-national-and-international-contexts>)

Swansea has been home to the Egypt Centre's collection since 1971. The majority of the collection belonged to Sir Henry Wellcome (1853 – 1936), a pharmaceutical entrepreneur. He was a keen collector of material culture from all cultures but was particularly keen on medical artefacts as he wanted to create a *Museum of Man*. When he died, he had over one million artefacts in his collection some of which were distributed to museums around the world. Ninety-two boxes of ancient Egyptian artefacts were sent to the Classics Department, Swansea University, under the care of Dr Kate Bosse-Griffiths. After securing Heritage Lottery funding the Egypt Centre was built and opened to the public in 1998.

The Egypt Centre provides a connection to ancient cultures. An objects story does not end when it is placed in a museum. The Egypt Centre is Wales' only museum of Egyptian antiquities and the journey of these objects to Swansea are part of their history.

## The Four Purposes

Museums are perfect places to put the Four Purposes into practice. These are just some of the ways the Egypt Centre feeds into them

### 1. Ambitious, capable learners, ready to learn throughout their lives.

- Provide new contexts for pupils to develop and use their learning
- Set new challenges
- Develop critical thinking skills

### 2. Enterprising, creative contributors, ready to play a full part in life and work

- Developing ideas
- Creative problem solving
- Team work
- Expressing ideas and emotions



# Planning your Visit

## The Four Purposes cont...

### 3. Ethical, informed citizens of Wales and the world

- Finding and Evaluating evidence to form views
- Engaging with contemporary issues
- Understand how actions have an impact on the world
- Develop their knowledge about culture in the world, now and in the past
- Understanding the rights of others and exploring diversity of society

### 4. Healthy, confident individuals, ready to lead fulfilling lives as valued members of society

- Developing values and beliefs
- Building and maintaining mental and emotional wellbeing through developing confidence, resilience and empathy
- Develop the confidence to participate in performance
- Forming positive relationships
- Overcoming challenges



## Teachers' Panel

Help shape the Egypt Centre's Learning Programme and participate in our exciting CPD Programme.

We are looking for teachers to join our Teachers' Panel and help steer and shape the Egypt Centre's Learning Programme

For more information visit:

<https://www.egypt.swan.ac.uk/teachers-panel/>



# Planning your Visit

## What We Offer

### Museum Facilitated Visit (groups of up to 40 children)

A half day visit 10am-12pm or 1pm-3pm.

Your group will do 4 activities which will be facilitated by Museum staff and volunteers. Your class will be split into two groups, half of which will start in the *House of Death* gallery and the other in the *House of Life* then swap over.

The museum has a designated space for school groups to have lunch if you need it. Please ensure you have enough adults to supervise all groups and that children bring a packed lunch.

### Outreach

If you are interested in an outreach session where we visit your school with our activities, please email [egyptcentre@swansea.ac.uk](mailto:egyptcentre@swansea.ac.uk) to discuss your specific needs and discover what we can offer.





# Useful Information

## How to Book

To check availability, please call 01792 295960 or email [egyptcentre@swansea.ac.uk](mailto:egyptcentre@swansea.ac.uk). You will be booked in and issued with a booking form. Please use this pack to choose your activities and return the booking form to the Museum. **Please note** your booking is provisional until we receive your completed booking form. We only hold provisional bookings for 1 week due to high demand.

Deleted sentence

## Before Your Visit

To save time on the day, please ensure that your group is split into two groups (groups up to 40) before arrival. Please ensure that you arrive and depart on the times you gave on your booking form as best you can. The Museum uses these to timetable your activities and so any changes should be passed onto the Egypt Centre as soon as possible.

## Prices

**Museum Facilitated Visit**—£3 per child

**Please note** there is a 50p charge for absent children to cover the cost of the materials prepared. If you need to cancel your visit, please let the Museum know immediately. We require 10 working days notice of a cancelled visit. Please note there is a possible 50% charge for any cancellations after this point.

Please make it known when booking how you intend to pay as this will affect how we produce your invoice. We will need to know this prior to your visit.

**Note: All cheques must be made payable to *Swansea University*.**

Our museum gift shop has ancient Egyptian themed souvenirs starting at 75p. We also offer a 'goody bag' service made up to your chosen price. If you require this service or time in the gift shop please make this clear in your booking. Please note that time in the gift shop may take away from your activity time.

## Safety Information

Safety information to plan your risk assessment is available on our website <http://www.egypt.swan.ac.uk/index.php/safetyinformation>



# The House of Life

7

The *House of Life* is our upstairs Gallery. It focuses on the daily life of the people of ancient Egypt. The *House of Life* takes you on a journey starting in Prehistoric Egypt. It is also home to our oldest object: a hand axe which may be 1 million years old. Children have the chance to learn about ancient [Egyptian home life and toys and games](#).

## Activities

### Explorer Buckets (30 Minutes)



This activity is all about understanding that the objects in the gallery were discovered by explorers and were owned by ancient Egyptians many years ago! Some of the objects are similar to ones we use today!

Each bucketed has a theme and children will be encouraged to sort the images into types and look for them. The children will be encouraged to 'tell a story' using the pictures if they have time! Children are encouraged to tell others in the group what they have discovered.

## Education Area

### Story Time (30 Minutes)



Settle down for some quiet time and hear an ancient Egyptian story. Our Education Area is transformed into a comfy sitting area for your group to rest after their activities in the galleries. Our ancient Egyptian Stories are told with actions and we encourage your group to join in.

You can even do some colouring while you're listening!



# House of Death

The *House of Death* is our downstairs gallery which explores the funerary culture of ancient Egypt. Search for the animals and Gods amongst the objects and much more!

## Activities

### Animals and Gods (30 Minutes)



The children will have the chance to dress up as the gods and goddesses of ancient Egypt find out about the many different types of animal that lived in ancient Egypt. Children will then play the 'guess the animal in the bag' game.

### Food and Drink (30 Minutes)

Discover all sorts of food and drink that the ancient Egyptian use to enjoy. Compare them with what we eat today! The children will have the opportunities to make an offering tray out of playdough, just like the Egyptians made out of clay as offerings for the dead.





# Booking Agreement

## Role of The Egypt Centre

For a Museum led visit we will provide trained activity leaders to work with the groups of children. All staff working with your children are fully-enhanced DBS checked. Activity leaders are not expected to supervise and discipline children, this is the responsibility of the School Teachers.

We will endeavour to provide as many of the activities chosen by the school in the time available. If the school arrive late for whatever reason, it may be necessary for activities to be shortened or an activity to be dropped altogether. We will provide all materials and equipment needed for each activity. We will also provide each child with a clipboard, pencil and work-pack for their use during the visit where applicable. For all-day visits we can provide a safe area for lunch near toilet facilities as close to the museum as possible. We welcome feedback from schools and each school is given a questionnaire to return to the Museum after their visit.

## Role of the School

The school should make every effort to arrive at the agreed time. If for whatever reason the school is running late, they should make every effort to contact us and keep us informed. During the day, the school will ensure the equipment and materials that are to be used for subsequent school groups and the public are not being misused. The school must also ensure respect for other visitors to the Museum at all times.

Ensure adequate insurance cover for the group and leaders. A member of school staff should supervise each group of children at all times and ensure good behaviour throughout the day. In particular, all teachers must: Make sure they have adequate staff supervision using the ratios laid down by their institution. (0-2 years = 1 adult to 3 children, 2-3 years = 1 adult to 4 children, 3-7 years = 1 adult to 8 children, 7 years += 2 adults, for up to 20 children, add one additional staff member for every additional 10 children).

In case of an accident or a lost child, contact a member of the Museum staff immediately, who will then follow the Museum / University procedures.

Ensure that the appropriate group leaders carry any necessary medicine for the children with them at all times, with the permission of the parents/guardian.

Refrain from having possession of, or consuming, alcoholic beverages on the Museum premises, or from either verbally or physically abusing a child/young person.

Inform their group of behavioural expectations while in the Museum:

Group leaders should not allow members of their group to: make any sectarian, racist, sexist or other offensive remarks toward any person or other group, vandalise Museum property, leave litter in the Museum/University grounds.

The school will pay £3 for each child and 50p for any work packs not used due to absence of Children. (Please make cheques payable to **Swansea University**). If the school has any concern please report it to a member of staff.



# House of Life Gallery Map

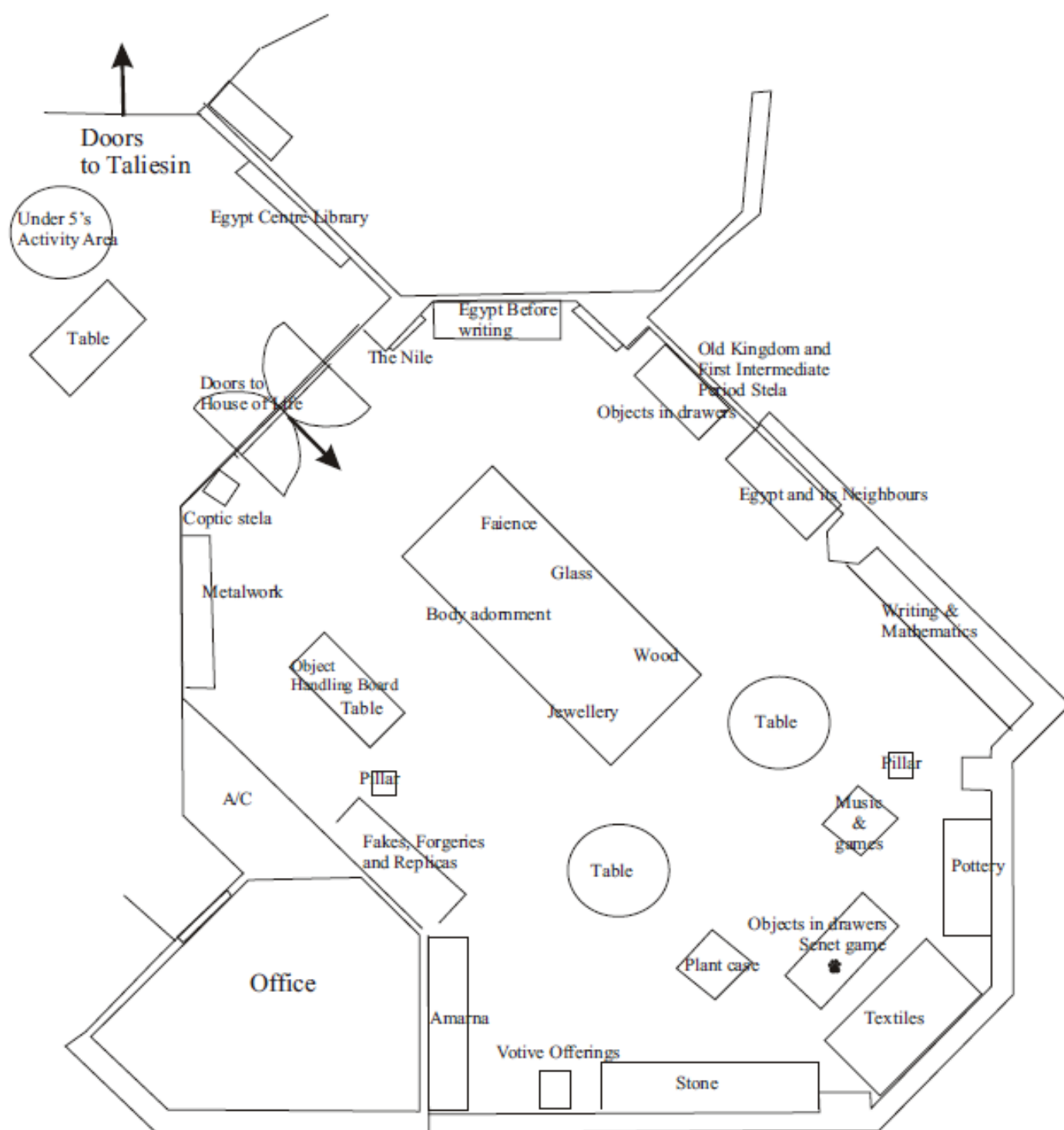



# Example Booking Form

## Egypt Centre School Booking Form

Please ensure your completed booking form is returned to [egyptcentre@swansea.ac.uk](mailto:egyptcentre@swansea.ac.uk) within 5 working days of booking your visit.



Date of visit/s					
Lead Teacher Name					
Full Name and Address of School					
Contact Email Address					
Number of Children					
Age of Children					
Expected Time of Arrival					
Expected Time of Departure					
Do you require a comfort break on arrival? ( <u>this will</u> shorten your activity time)					
Would you like shop time <u>OR</u> goody bags? ( <u>shop</u> time may shorten your activity time)	Shop Time?		Goodie Bags? (£2, £2.50, £3, other?)		
Will you be paying on the day <u>OR</u> would you like an invoice to take back? <b>Please choose 1.</b>	Paying on Day?		Invoice to take back?		
Will you be paying by cash, cheque, card, or BACS? <b>Please choose 1.</b>	Cash		Cheque		Card BACS
Do any of your children have any special education or access requirements?					
<b>Museum Led: Choice of Activities</b> <ul style="list-style-type: none"> <li>See teachers pack for activity choices - <a href="http://www.egypt.swan.ac.uk/education/key-stage-2/">http://www.egypt.swan.ac.uk/education/key-stage-2/</a></li> <li>For a full day visit with groups of up to 40 children, please select up to 3 activities totalling 1.5 hours in each gallery. (For half day visits please select up to 2 activities totalling 1 hours in each gallery)</li> <li>For groups of over 40 children activities will be split over 3 areas. Please choose 2 activities totalling 1 hour in each gallery. Mummification and Senet are compulsory and will take place in the Education Area. Costume activity is not available for groups over 40. (Not suitable for half day visits)</li> </ul>	<b>House of Life (Up to 40 children = three activities. Over 40 children = two activities only)</b> <b>PLEASE NOTE COSTUME &amp; PYRAMIDS COUNT AS 2 ACTIVITIES</b> <ol style="list-style-type: none"> <li></li> <li></li> <li></li> </ol> <b>House of Death (Up to 40 children = three activities. Over 40 children = two activities only)</b> <ol style="list-style-type: none"> <li></li> <li></li> <li></li> </ol> <b>Education Area (Only for groups over 40)</b> <ol style="list-style-type: none"> <li></li> <li></li> </ol>				

Please date, sign and print your name below to state that you have completed the booking form and fully agree with the terms and conditions set out by the Egypt Centre.

Print Name		Sign	
Date			



# Other Activities We Offer

## Young Egyptologist Workshops



Each month the Egypt Centre offers a free workshop to a school who would otherwise not be able to visit the Museum. Our aim is to improve literacy and numeracy but most importantly to build confidence, self esteem and foster a love of learning. Our Young Egyptologist Workshops are designed for children aged between 7 and 11 who would otherwise not be able to visit the Museum. They may need extra educational enrichment or need a self-esteem or confidence boost. We give priority to schools in WIMD40 areas. For more information or to take part, please contact us on 01792 295960 or email [egyptcentre@swansea.ac.uk](mailto:egyptcentre@swansea.ac.uk)

## School Holiday Workshops

The Egypt Centre runs one-day workshops throughout the school holidays. Each workshop has a different theme from mummification and magic to hieroglyphs and explorers. Participants get the chance to learn about ancient Egypt with various hands-on activities as they explore the galleries and take part in fun arts and craft sessions, developing their creativity and giving them the chance to make something they can take home!

10 am—3pm.

Suitable for ages 6-11

More information and booking can be found on our website: [www.egypt.swan.ac.uk/events](http://www.egypt.swan.ac.uk/events)



## Museum Gift Shop

The gift shop is available for all visiting parties during their time at the Museum. There are many items geared towards school children, and at a very affordable price (items start from 75p). If you would like time in the Museum gift shop, please let us know so we can allocate sufficient time around your activities. This is often done during the lunch break, where children can visit the gift shop in small groups.

## Goody Bag Service

We can also provide a '**goody bag**' service which can be prepared in advance. This can make the visit easier for schools especially for larger groups, and if you are pressed for time.







*t h e*  
**EGYPT**  
*c e n t r e*  
*y g a n o l f a n*  
**EIFFTAIDD**

## Useful Contacts

### Main Office

(Enquiries and bookings)  
 egyptcentre@swansea.ac.uk  
 01792 295660

### Museum Manager

(Feedback and complaints)  
 Wendy Goodridge  
 w.r.goodridge@swansea.ac.uk  
 01792 295960

### Gift shop, Front of House Officer

(Invoices and goody bags)  
 Angharad Gavin  
 a.gavin@swansea.ac.uk  
 01792 602660

### Open Hours:

Tuesday—Saturday 10.00am — 4.00pm

Egypt Centre  
 Swansea University  
 Singleton Park  
 Swansea  
 SA2 8PP

01792 295960

[www.egypt.swansea.ac.uk](http://www.egypt.swansea.ac.uk)

***\*This pack is available in Welsh\****

